

# SolVista Golf & Ski Ranch Planned Development Overlay District Map

Township 1 North, Range 76 West of the 6th Principal Meridian,  
County of Grand, State of Colorado

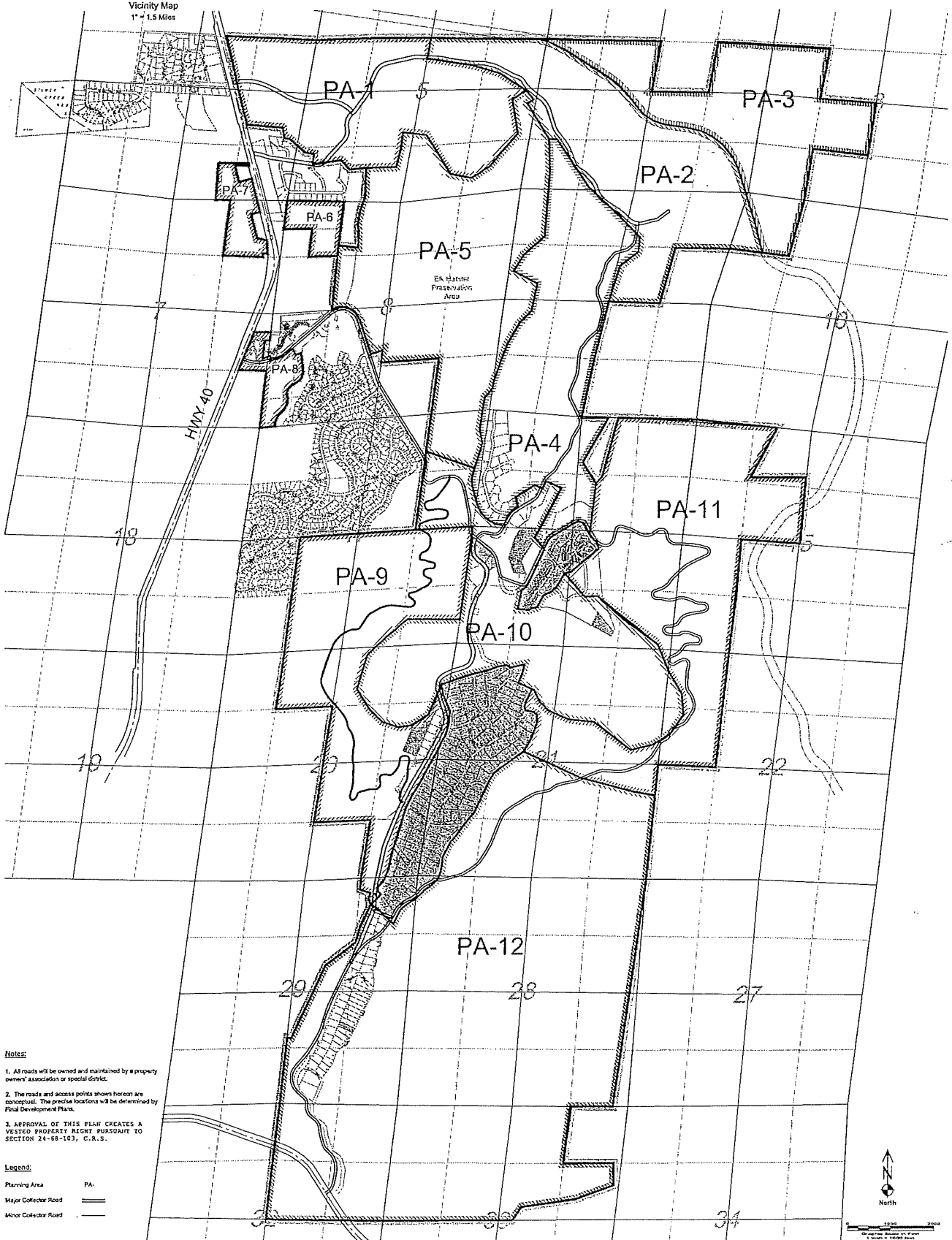

- Notes:**
1. All roads will be owned and maintained by a property owners' association or special district.
  2. The roads and access points shown herein are conceptual. The precise location will be determined by Final Development Plans.
  3. APPROVAL OF THIS PLAN CREATES A VESTED PROPERTY RIGHT PURSUANT TO SECTION 24-68-103, C.R.S.

**Legend:**

|                      |    |
|----------------------|----|
| Planning Area        | PA |
| Major Collector Road | —  |
| Minor Collector Road | —  |



Scale  
0 1000 Feet